

## Corner protection profiles - a safe matter

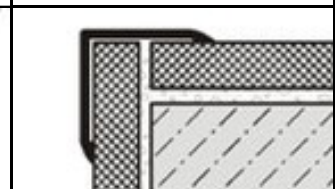
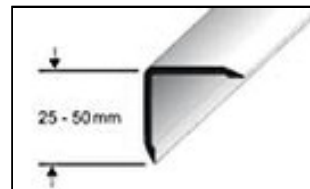
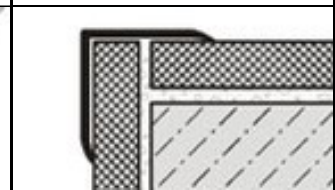
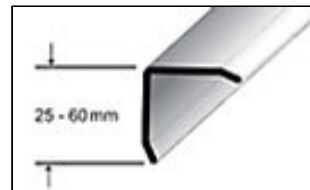
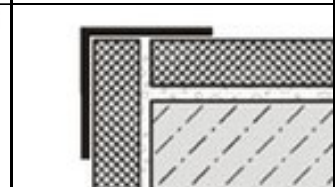
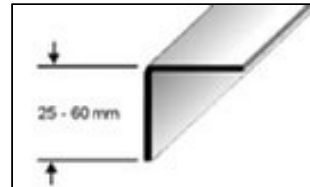
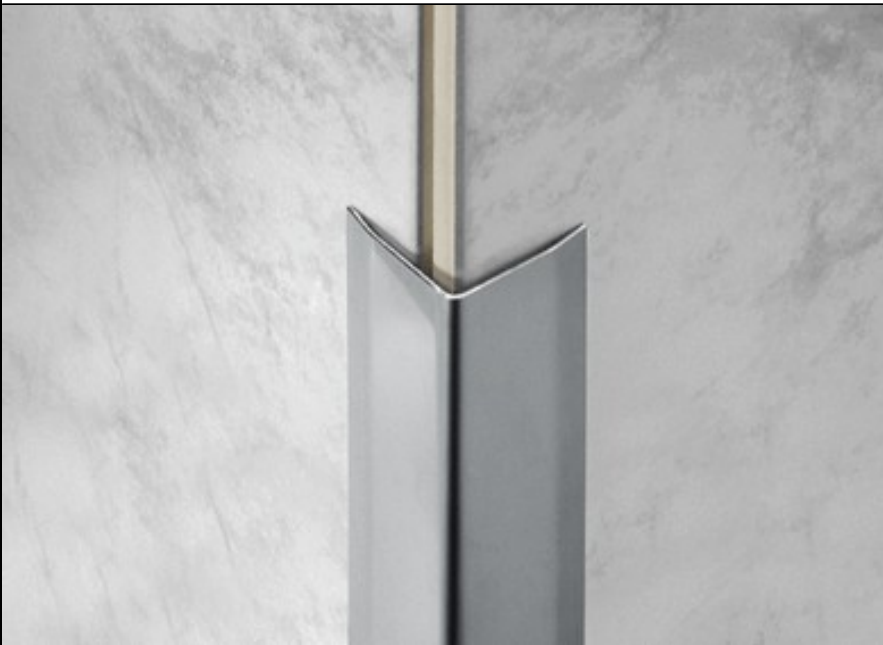

### Application:

DURAGARD corner protection profile for subsequent fitting are especially sophisticated corner profiles made of special steel, anodised or powder-coated aluminium. They were especially developed for the protection of tile edges or corners submitted to major stresses. DURAGARD profiles are also appropriate for industrial premises where hygienic requirements are applied. This includes hospitals and large-scale catering establishments.

These profiles however, can also be used for decorative design and are easy to clean.

### Material:

DURAGARD corner protection profiles are made of special steel V2A (1.4301) with protective foil, anodised aluminium or powder-coated aluminium.

### Characteristic features:

DURAGARD corner protection profiles of **special steel** are appropriate for areas subjected to major stresses. This also includes chemicals and acids. Also the mechanical resistance is meeting highest requirements. The special steel profiles are used for example in the foodstuff industry, hospitals, swimming-pools and breweries.

DURAGARD corner protection profiles of **anodised aluminium** and **powder-coated aluminium** are especially refined such that the surface usually does not change. The visible surfaces have to be protected against cement materials. Damages can be caused by scratching or abrasive objects.

The appropriation respect resistance to mechanical and chemical stresses is to be checked for the individual case.

**Handling:**

1. For subsequent adherence: Clean wall surface from any impurities.
2. Apply silicone to the insides of the corner profile.
3. Press the DURAGARD corner profile flush onto the edge and possibly secure against slipping until dry.
4. Any silicone emerging from under the edges is to be removed with cleaning material.
5. Remove the protective film covering special steel profiles.

**Care:**

For special steel profiles it is recommended to use chrome polishing solution. It will provide a bright appearance. In case special steel profiles are subjected to especially aggressive mediums they should be cleaned from time to time with mild cleaning materials. The cleaning materials have to be free from hydrochloric acid and hydrofluoric acid and must not be abrasive. Oxidation layers on aluminium profiles can be removed using polishing solutions. A permanent removal however is not possible.

**Data sheet**

Name	Material	Size
DURAGARD	Stainless steel standard, Stainless steel high gloss, Stainless steel polished 240 K, Mat. V2A (1.4301) [304]	from 25x25 to 60x60 mm
DURAGARD	Aluminium anodised, Aluminium powder coated	from 25x25 to 60x60 mm