

## Bending instead of breaking: Z-Flex profile by Dural

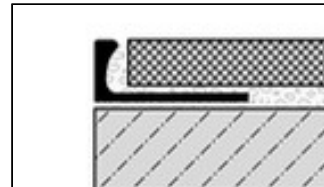

DUROSOL

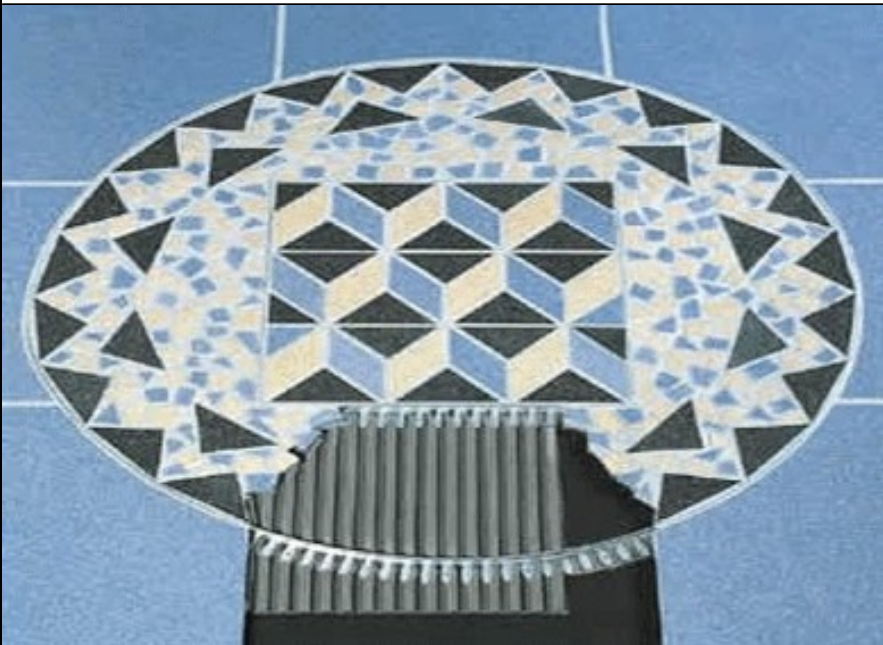
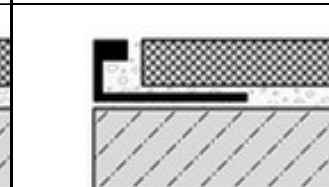

DUROSOL 5mil

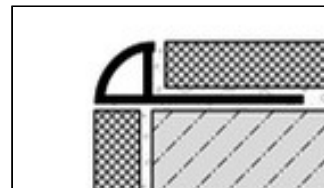

DURONDELL

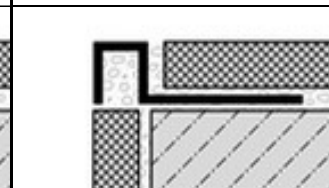

DURAPLUS



DURATRANS

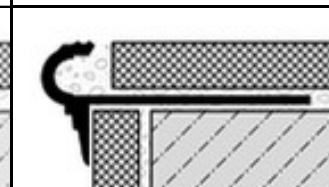

FLORENTOSTEP

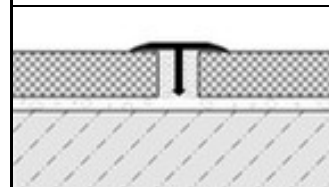

T-FLOOR

### Application:

Edging profiles with Z-FLEX stamping are formed in such a way that they can easily be bent into rounded shapes, curving either inward or outward. The smallest attainable radius depends on the material and the geometry of the profile so that there are no fixed values. The thinner the shell of the profile, the smaller the radius to which it can be bent. Apart from their protective function, edging profiles with Z-Flex stamping also meet the highest demands for decorative appearance. They make smooth joints and transitions, between carpets and laminate or parquet floors, for example.

To ensure the curve is even, it is recommended that the Z-FLEX CURVER be used for bending the profiles. This is a tool that makes it possible to bend the profiles more accurately than is possible by hand with the minimum of effort.

### Material:

The Z-Flex-Profile are not only available with surfaces of aluminium and brass, but also with refined surface of polished brass, chromium-plated brass and anodised aluminium.

Information on the properties of materials and their areas of use can be found in the various product data sheets.

The following versions of easy-to-bend Z-Flex perforation are available DUROSOL angle profile up to 40 mm, DURATRANS transition profile, DURAPLUS separating profile and DURONDELL quarter rounded profile:

**DUROSOL**

Square edge profile

**DUROSOL 5mil**

Square edge profile with visible 5 mm edge

**DURONDELL**

Quarter round profile

**DURAPLUS**

Box section profile, Transition profile

**DURATRANS**

Transition profile of up to 12,5 mm

**FLORENTOSTEP**

Stair nosing profile of up to 13,5 mm

**T-FLOOR**

(also suitable for binding with the Z-Flex curver)