

Balcony corner profile for gravel bases with drainage holes

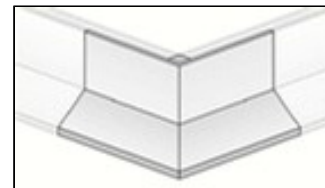

Corner pieces

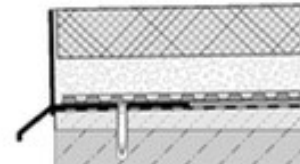
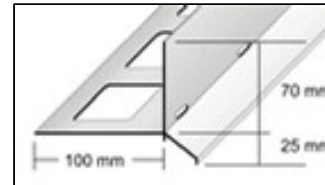
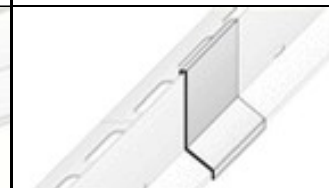

Connecting pieces

Application and function:

DURABAL profiles for laying pavings on gravel are special aluminium balcony edging profiles with a robust angled shape incorporating an inclined gutter and drainage holes in the front edge intended for use at the open edges of balconies and terraces.

DURABAL profiles for gravel bases are used in conjunction with loose laying of large-sized self-bearing pavings, such as concrete paving stones, ceramic or natural stone, onto loose gravel bases or stilted or terrace bases.

The DURABASE-DD drainage mat placed under the paving reaches to within a bout 5 mm of the front edge.

DURABAL profiles for gravel bases are placed with the perforated square leg touching the edge of the built-in sealing and aligned as necessary flush and at the right height. For drainage purposes the profile should be laid so that penetration by rain water runs off through the drainage holes in the front of the DURABAL profile, level with the lowest drainage level of the balcony construction. The DURABAL balcony profile should be secured by appropriate methods that do not hinder in any way the drainage of water through the holes at the front. Pavings should be laid so that their edges are flush with the upper edge of the DURABAL profile where they meet its edge.

Material:

DURABAL profiles for gravel bases are available in three different material finishes, natural aluminium, anodised aluminium and (grey) powder-coated aluminium, and in installation heights from 70 mm to 95 mm. Profile bindings and corner pieces are also available to supplement the range.

Properties and usage:

DURABAL aluminium profiles are highly robust and are highly resistant to weathering. The powder coating of the aluminium is also colour-fast, UV resistant and resistant to weathering. The visible surfaces should be protected from abrasion especially when the profile is installed and when pavings are laid. The usage of DURABAL with regard to the expected chemical and mechanical influence should be assessed in some special cases.

Care and maintenance:

Regular cleaning of balcony profiles is recommended to maintain their attractive appearance and avoid corrosion. The edge support and long-term drainage of balconies and terraces is ensured by the use of the DURABAL profile for gravel bases.

Data sheet

Material	Installation height / Total height	Contact legs
Aluminium natural, Aluminium anodised or Aluminium powder coated	70 mm / 90 mm	100 mm